



CHASSIS SPECIFICATIONS

- DynoMax® chassis: semi-monocoque construction of 8" x 3" x 1/4" tube with welded components
 - 10,000 lb. Class III receiver hitch with electrical connector and chrome cover
 - 2-year/unlimited mile chassis warranty
- 42' chassis: GVWR – 47,500 lbs.; GCWR – 54,500 lbs.
- Wheelbase: 42' – 270"
- Engine: Caterpillar 14.6L C-15 515hp with 1650 lb/ft torque at 1200 rpm
 - Jacobs 3-stage engine brake with brake light activation
 - Electronic Control Module (ECM) for engine diagnostics
 - Alternator: 200 amps
 - Engine oil reservoir
 - Hydronic engine block preheat
 - 5-year/100,000-mile engine warranty
- Transmission: Allison 4000 MH
 - Six speed automatic with 2 overdrive gears
 - Keypad electronic shifter with digital display
 - 5-year/unlimited-mile transmission warranty
- Driveline: Dana Spicer 1810 series
- Suspension:
 - Front: Dana Automocion independent front suspension with double wishbone construction and full air suspension system, disc brakes, IPD anti-sway bar, and Koni adjustable shock absorbers
 - Rear: Ridewell drive and tag axle air suspension systems with air springs and Koni adjustable shock absorbers
- Drive axle ArvinMeritor with 4.30 differential ratio
- Steering: Fully-integral, full time hydraulic power steering gear with tilt and telescoping column
- Electronic cruise control
- Williams electronic throttle and Bendix brake pedal
- Service brakes: Full air brakes with ABS and automatic slack adjusters
 - 17" x 1.75" (disc) front axle
 - 14.5" x 10" rear axle
 - 16.5" x 7" tag axle
 - Automatic Traction Control (ATC)
- Tires (steel-belted radials):
 - Front axle – 315/80R x 22.5"
 - Rear drive and tag axle – 12R x 22.5"
- Wheels:
 - Front – two 9" x 22.5" aluminum alloy wheels
 - Rear – two 8.25" x 22.5" aluminum alloy wheels and two 8.25" x 22.5" inner dual steel wheels
 - Tag – two 8.25" x 22.5" aluminum alloy wheels
- Battery: Two heavy duty 8D's on rollout with 12-volt disconnect
- Fuel capacity: 110 gallons (dual fuel fills, driver and passenger sides)

- Service center: Access to fuel/water separator (primary), secondary fuel filter (Caterpillar with primer pump), fresh oil reservoir, switch for oil reservoir pump, reader ports, circuit breakers, chassis battery disconnect, 12-volt fuse box, and tow vehicle adapter

CONSTRUCTION HIGHLIGHTS

- 102" wide body
- Tube steel cage structure
- Vacuum-bonded roof, walls and floor with expanded polystyrene insulation
- R20-value roof insulation
- All fiberglass exterior
- One-piece reinforced fiberglass roofcap
- Exterior riding height: 12' 1" (including roof air)
- Finished interior height: 79"
- Sound and vibration dampening material throughout

DRIVER COMPARTMENT AMENITIES

- 6-way power-operated driver and passenger seats (driver seat offers a sliding seat cushion and the passenger seat provides a power footrest).
- 30th Anniversary Logo embroidery on cab chair headrests
- Custom contoured dash and overhead with instrumentation
- L-shaped driver's console with granite top
- Vacuum formed overhead with Soft Touch covering
- Burlwood dash panels
- Teleflex gauges include: speedometer, tachometer, air pressure, oil pressure, transmission temperature, volt meter, water temperature, fuel level, odometer, and trip meter
- SilverLeaf HMS060 house monitoring system
- SilverLeaf VMS 200 EL digital engine monitor/travel information center
- OnStar System: Satellite technology to provide road assistance, emergency services, accident assist, route support, ride assist, information and convenience services, and stolen-vehicle location
- Wrap-around windshield with shade band
- Power sun visors concealed in overhead console
- Pantograph dual-motor windshield wipers with delay and washers
- Heating/cooling/defrost unit in dash (separate dual control for driver/passenger)
- Ducted overhead defrost system
- Power privacy blackout curtain
- Concealable color rear-view monitor with AM/FM/XM stereo and compact disc controls with remote CD changer and two speakers
- Side-view cameras
- Back-up alarm
- 40-channel CB radio with antenna
- Directional cab lights

- 18" SmartWheel burlwood steering wheel with controls for horn, head light flash, marker light flash, cruise functions, wiper functions, and high beam light
- Non-skid entry steps
- Bound floor carpets for entry steps
- Tile entry landing
- Swing-out valet tray
- Cigarette lighter
- 30th Anniversary commemorative plaque

GENERAL CONVENIENCES

- Custom crafted light, medium, or dark oak cabinetry (Cathedral-arched raised panel or raised panel) and woodwork with semi-gloss finish.
- Cabinet doors have knobs and drawers have pulls
- Self-closing drawer guides
- Pocket doors have stick and cope frame with raised panels
- Padded vinyl ceiling
- Sculpted carpet in living room
- Wallpaper throughout (designer-coordinated)
- Fluorescent and halogen lighting throughout
- Rope lighting at galley and vanity toekicks, living room/dinette/bedroom window boxes, slide-out room soffits and lighted valances
- Fabric-wrapped window boxes and valances in living room, dinette, and bedroom with wood sill
- Wall sconce lighting in living room with dimmers (varies by floorplan)
- Blackout shades in living area
- Granite counter- and tabletop surfaces throughout
- 30" LCD TV (mounted in living area)
 - Companion DVD player
- VCR with remote control
- VCR remote extender (allows remote operation for both TVs from VCR)
- Bose home theater system with DVD
- Remote operational switching for front and rear TV, VCR, and Bose DVD
- Pre-wired for satellite dish and solar panels
- Washer/Dryer combo
- Ironing board
- Carpeted step stool
- Vacuum cleaner
- Built-in safe with combination lock
- Telephone jacks (two in living area, one in bedroom and one in storage bay)
- Aisle light illuminating stepwell
- Burglar alarm (inside/outside protection) with key fob controlled keyless entry
- Smoke detector
- Carbon monoxide detector
- Fire extinguisher
- LP gas detector system with auto shut-off at tank
- Entry door grab bar (lighted)
- Power step slide cover

- Emergency roadside service
- 2 Customized 30th Anniversary commemorative jackets

GALLEY AMENITIES

- Granite countertops with edge detail
 - Decorative splashguard located at forward end of countertop
 - Tile backsplash and wall surface with granite accents
- Double bowl stainless steel sink with granite covers and single-lever faucet with pull-out sprayer
- Thermostatically-controlled variable speed fan with rain sensor, insulated cover, and dome stop switch
- 12 cu. ft. four door refrigerator/freezer with icemaker and raised panel inserts on doors
- Advantium Speed Cook oven with power hood
- Recessed 2-burner electronic-ignition gas cooktop with granite cover
- Wood window box with mini blinds on galley window
- Wall module cabinets, with granite top, adjustable shelves, and double doors
- Dining area seating variations: wall-mounted dining table with two fixed chairs and two folding chairs, wall-mounted café dinette, or café dinette sleeper (all choices include granite dining table)
- Tile flooring on main floor, carpet in slide rooms
- Decorative dinette light
- Pull-out bread board
- Cutlery tray in top drawer of galley
- Pull-out trash receptacle
- Glassware cabinet

BATH AMENITIES

- Custom granite countertops with edge detail
- Tile backsplash and wall surface with granite accent
- Solid-surface vanity sink (under-mount)
- Decorative bar light for each vanity
- Vanity overhead with mirrored doors
- 30th Anniversary towel set
- Towel ring at each vanity sink, towel bar and toilet paper holder
- Round shower with solid-surface shower walls with tile and granite design band
- Etched glass shower enclosure with coordinating finish
- Insulated skylight above shower
- Light in shower
- Electric china toilet
- Water pump switch
- Thermostatically-controlled variable speed fan with remote switch, rain sensor, insulated cover and dome stop switch
- Hand-held shower unit with pressure-balancing mixer valve
- Hardwood pocket door with full-length mirror

- Tile flooring
- Mini-blinds with fabric valance on bath window
- Clothes hamper (pull-out with two bags)

BEDROOM AMENITIES

- 60" x 77" mattress with radius corners
- Bedroom cabinet with dresser drawers
- Upholstered headboard
- Bedspread with reversible sham and three throw pillows
- 30th Anniversary embroidered throw pillow
- Two nightstands with granite countertops and edge detail
- Ceiling lights controlled by 3-way switches
- Wardrobe with lighting and cedar-lined ceiling
- Wall sconce lighting
- Remote switching: generator start/stop, Hydro-Hot (diesel, electric, and engine preheat), hydronic heat, curb lights, floor lights, and over-the-road A/C blower
- 30" LCD color TV
 - Companion DVD
- VCR remote extender
- AM/FM auto-reverse cassette stereo with two ceiling speakers
- Adjustable reading lights
- Telephone jack
- Carpet

HEATING AND COOLING SYSTEMS

- Comfort Control Center, controls the following:
 - Diesel-fired hydronic central heating system (50,000 BTU) with zone control
 - Three 15,000 BTU low-profile roof mounted air conditioners with heat pumps
- Dash area
 - A/C and heating system with separate dual controls for driver/passenger (45,000 BTU heating, 19,000 BTU cooling)

POWER SOURCES

- 12-volt battery boost system
- Automatic low-voltage generator start
- Onan 12.5 kW quiet liquid-cooled diesel generator with remote start/stop (on electric roll-out)
- 3000-watt solid state, true sine wave inverter and 130-amp solid state converter/charger with 15-amp chassis battery charge system
- Digital power package (battery monitoring system)
- 50-amp shore service with cord with power reel and 30-amp adapter
- Two AGM domestic deep cycle batteries on rollout with 12-volt interior disconnect switch at systems monitoring panel
- Two 8D chassis deep cycle engine cranking batteries on rollout with 12-volt disconnect in service center
- 50-amp shore service surge protector

PLUMBING FEATURES

- Heated and insulated fiberglass plumbing bay
- On-demand hydronically heated hot water system with electric back-up
- 10 gallon electric hot water heater
- 12-volt on-demand water pump
- Three water pump switches (plumbing bay, dash, and bath)
- Low-point drain valve for fresh water plumbing
- Black and gray water tank flush system
- City water-to-water tank fill located in plumbing bay
- Water filtration system
- Exterior hot/cold running water with spray fixture (plumbing bay)

Tank Capacity (Gallons)

Floorplan	Gray	Black	Fresh Water	LP	Fuel
42' Chalet	63	63	99	19.4	110

EXTERIOR CONVENIENCES

- Powder-coated steel frame structure entry door with auto-hold, deadbolt, key fob keyless entry, and screen door
- Lighted entry door assist grip
- Patio light
- Electric entry doorstep with automatic override at ignition
- Standard awning package:
 - Carefree window awnings
 - Carefree Omega II slide cover on DS bedroom and DS living room/galley slides
 - Carefree Kover II slide cover over PS living room/galley slides
 - A&E electric Weather Pro patio awning with or without slide room
 - Carefree pull rod
- Omnidirectional TV antenna with coaxial cable and 12-volt boost
- Telephone and cable TV hook-up
- Two 120-volt receptacles, 12-volt receptacle, coaxial cable and phone jack (storage bay)
- Compressed air supply hook-up (steering bay)
- Two roof-mounted chrome air horns
- Thermostatically-controlled/heated remote control chrome cab mirrors with turn signals and adjustable arms
- HWH 4-point CAN automatic air leveling system
- Daytime running lights
- Fog lights
- Large halogen headlights
- Lighted, pass-through exterior storage bays with carpeted liners and insulated doors
- 10,000 lb. Class III receiver hitch with electrical connector and chrome cover
- Full rear mud flap with stainless steel trim
- Power bay door locks
- Key-One system

- Polished stainless steel exhaust pipe tips for generator, hydronics, and engine
- Undercoating
- High quality clear-coat exterior with chip-guard paint-protection coating on wheel well flare
- Exclusive paint design (four color schemes)
- Bronze tone reflective dual-pane insulated windows
- Shore cord on power reel
- 30" aluminum step ladder
- Paper towel holder
- Emergency road kit
- Two fuel cap holders
- Engine light with remote reel

SLIDE-OUT ROOM DIMENSIONS

Floorplan	Slide Out	Width	Depth
42' Chalet	Living Room	12' 4"	2' 8"
	Galley	12' 9"	1' 8"
	Bedroom	6' 10"	2' 0"

SLIDE-OUT ROOM SPECIAL FEATURES

- Push-button slide-activation control panel located in dash for front slides and bedroom cabinet for bedroom slide
- 42' Chalet has the X-Slide extension mechanism to operate the galley slide room and the HWH Level-Out extension mechanism operates the living room slide room
- HWH single cylinder extension mechanism on the bedroom slide
- Pleated blind on forward and rearward ends of slide with HWH X-Slide
- Emergency hand-operated winch for slide rooms with HWH extension mechanism
- One-piece molded fiberglass vacuum-laminated exterior slide room wall

- Slide room topper/window awning (roadside and bedroom slides only)
- Automatic travel lock when slide room is retracted

OPTIONAL EQUIPMENT

- Digital dash
- Buddy power passenger seat
- Massage/heated cockpit seats with adjustable headrests
- Digital Projection Cinema Package
 - 68" power remote-controlled projection screen
 - NEC DLP projector
- Custom Computer table w/granite top
- Custom style J-sofa
- Light, medium or dark cherry cabinetry
- Walnut cabinetry
- Light maple cabinetry
- Stained glass insert in pantry overhead
- Stainless steel package
- GPS navigation system
- Amana 21.6 cu ft 120 volt electric refrigerator (includes two additional AGM batteries)
- Sunscreen windshield cover
- Bay roll-out storage tray(s)
- Bay dual-directional roll-out storage tray(s)
- Radiant floor heating (galley and bath)
- Tire monitoring system
- Exterior Stainless Steel trim package
- 01 Girard electric box patio and window awning package
- 02 Girard electric double box patio and window awning package (triple slide only)
- 3M nose coat
- Universal Remote
- Factory delivery

42' Chalet 30th Anniversary

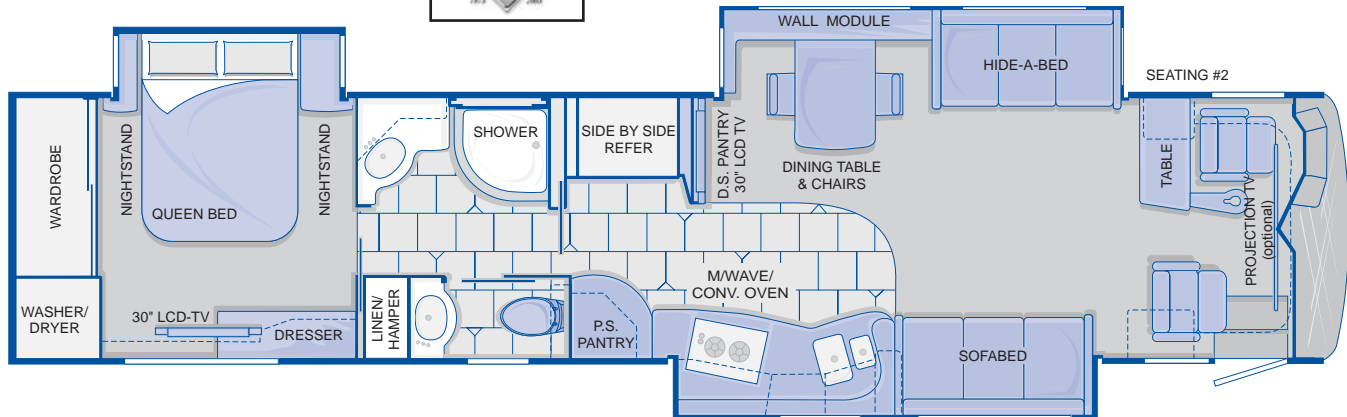

Proprietary Information

The information herein is the property of Country Coach, Inc. and or its subsidiaries, without written permission, and copying, transmittal to others, and any use except that for which it is loaned is prohibited. Due to constant product improvements, styling, design, equipment and construction are subject to change without notice or obligation. Please check revised date for current floor plan. We reserve the right to make changes, but are happy to verify any item on request.